



TSL-KVW INSTALLATION

ICWUSA.com, Inc.

If you have any questions please call Toll Free 1-800-558-4435

► **MAXIMUM MONITOR WEIGHT:
25 LBS (11.3 KG)**

When mounting to studs, ICW recommends using only wood or metal studs. This is the basic method to mount the arm on a stud. Check building code regulations in your area for additional requirements.

REMOVE BEAUTY CAP

Using a hex drive, remove screw and lift off plastic cap on one end of track. Save cap to put back on when track installation is complete.

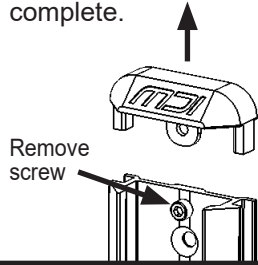

NOTICE: ICWUSA.COM, Inc. provides the appropriate hardware fasteners to match the majority if not all standard monitors and devices. It is the responsibility of the installer / integrator to ensure that the screws and fasteners have the adequate thread engagement. The rule of thumb is that the thread depth is greater than the diameter of the hole or 4 full turns of 360 degrees of thread engagement. It is also the responsibility of the installer / integrator to ensure that they do not damage the monitor or device by using a screw or fastener that is too long for hole and therefore damaging the unit by inserting too far.

ULTRA TRACK

FOR WOOD STUD

Locate the wall stud and mark top hole of the wall track. Drill a 11/64 pilot hole, insert a #14 screw and tighten slightly. Using a level, mark lower holes evenly spaced and drill pilot holes. Insert #14 screws and tighten. Use all screws.

FOR METAL STUD

#14 **wood** screws are supplied with unit. If installing into **metal studs** you will need to replace these with proper metal stud fasteners or the provided snap toggles. (See below) All hardware used to secure track mount must have a proper countersunk head.

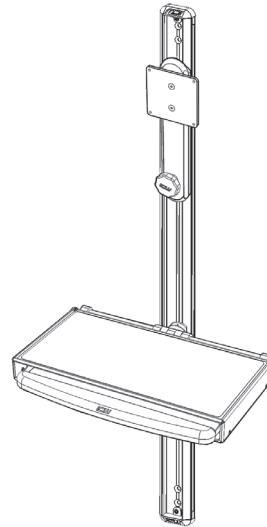

Monitor Mount and WorkSurface Tray TSL-KVW

ATTACH WALL PLATE TO TRACK

Unit is shipped with track adapters pre-assembled onto wall plates. Slide track adapters into wall track from either top or bottom. Position wall plates to desired location on track.

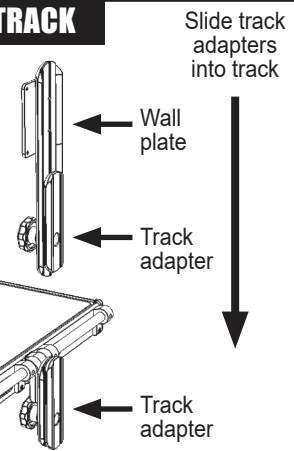

Firmly tighten adjuster knobs. Attach beauty cap.

Snap Toggle Instructions

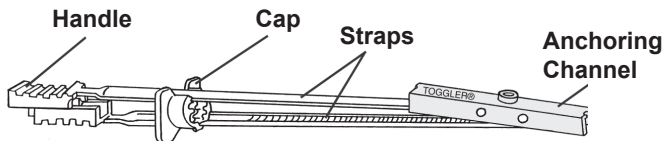

The plastic straps and cap washer are positioning and retention elements only. They do not otherwise function as anchoring elements. Holding is dependent only on a metal bolt to metal channel connection. The SnapToggle anchor complies with all existing fire codes for critical applications.

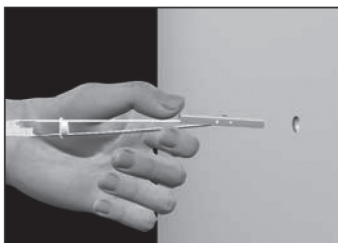

Drill 1/2" hole. Hold metal channel flat alongside plastic straps and slide channel through the hole. Minimum clearance behind wall is 1-7/8"

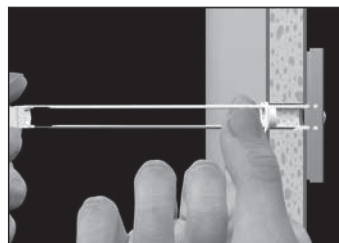

Hold ends of straps together between thumb and fore-finger and pull toward you until channel rests behind wall. Ratchet cap along straps with other hand until flange of cap is flush with wall.

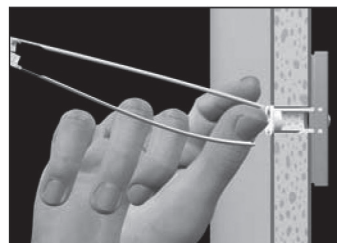

Place thumb between straps at wall. Push thumb side to side, snapping off straps level with flange of cap.

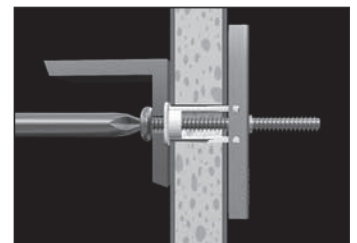

Place track over flange. Insert provided bolt and tighten until snug against track, then stop.