



# ELITE 5220 FRONT BEARING REPLACEMENT

ICWUSA.com, Inc.

If you have any questions please call Toll Free 1-800-558-4435

## RELEASE ARM RESISTANCE

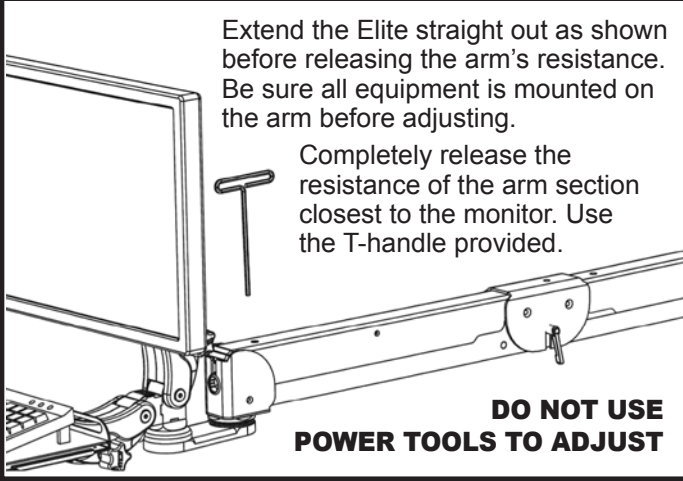

Extend the Elite straight out as shown before releasing the arm's resistance. Be sure all equipment is mounted on the arm before adjusting.

Completely release the resistance of the arm section closest to the monitor. Use the T-handle provided.

**DO NOT USE POWER TOOLS TO ADJUST**

## REMOVE MONITOR

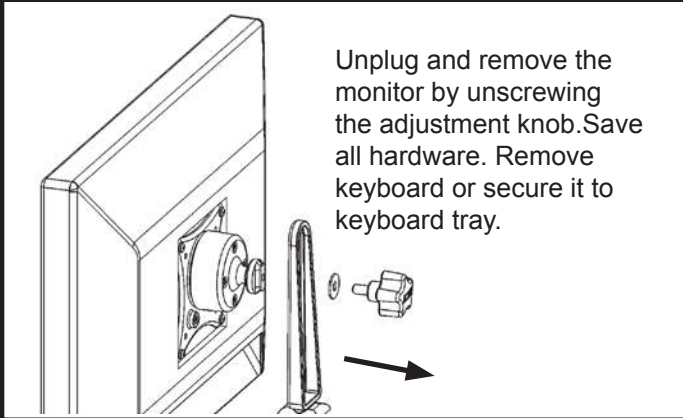

Unplug and remove the monitor by unscrewing the adjustment knob. Save all hardware. Remove keyboard or secure it to keyboard tray.

## REMOVE ARM COVERS

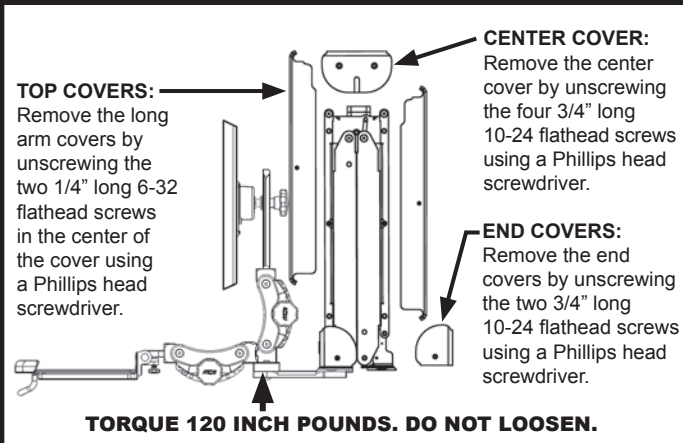

**TOP COVERS:**  
Remove the long arm covers by unscrewing the two 1/4" long 6-32 flathead screws in the center of the cover using a Phillips head screwdriver.

**CENTER COVER:**  
Remove the center cover by unscrewing the four 3/4" long 10-24 flathead screws using a Phillips head screwdriver.

**END COVERS:**  
Remove the end covers by unscrewing the two 3/4" long 10-24 flathead screws using a Phillips head screwdriver.

**TORQUE 120 INCH POUNDS. DO NOT LOOSEN.**

If you have any questions, please call our customer service representatives. They will be able to answer your installation questions.

**Toll free 1-800-558-4435**

## DANGER!

**The Elite arm contains high pressure gas springs. The following cautions MUST be observed to avoid serious injury.**

- **Do not** attempt to adjust the Elite arm until all components are mounted (monitor, keyboard, etc.)
- **Arm must be completely horizontal** (extended) before adjusting the arm's tension. Failure to do so will damage the arm and void the warranty.
- **NEVER loosen or remove any of the shoulder bolts.** Doing so will cause the arm to immediately come apart with tremendous force, and could cause serious injury.
- If equipment requiring AC power is mounted to this unit, have a certified electrician inspect the installation.
- Failure to install this unit according to these instructions will void all ICW warranties. If installed incorrectly, ICW is not liable for any damage or injury caused by the unit.

## IMPORTANT

**DO NOT use power tools to assemble or adjust the arm. Use hand tools ONLY.**

## REPLACE BOLT & BEARING ASSEMBLIES

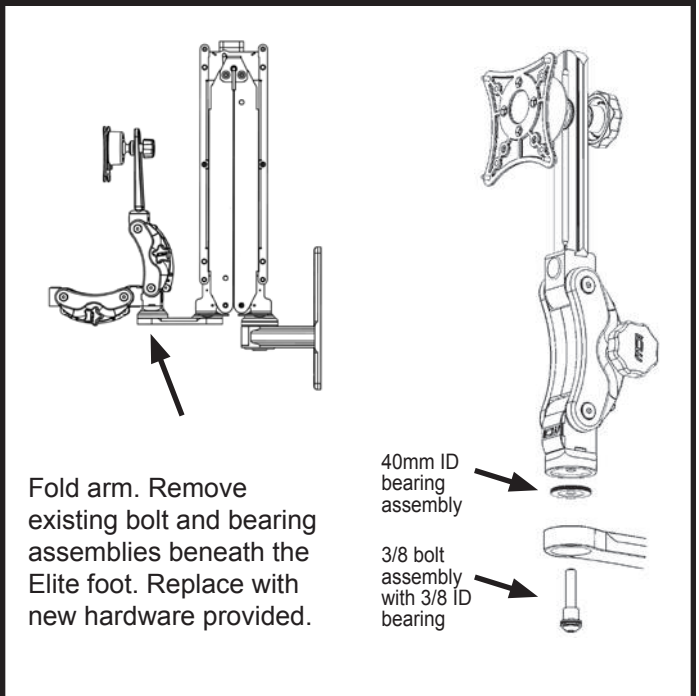

Fold arm. Remove existing bolt and bearing assemblies beneath the Elite foot. Replace with new hardware provided.

40mm ID bearing assembly

3/8 bolt assembly with 3/8 ID bearing

# ELITE 5220 REAR BEARING REPLACEMENT

Replacing the rear bearing assemblies on the Elite 5220 may require two people.

## REMOVE ARM COVERS

**TOP COVERS:**  
Remove the long arm covers by unscrewing the two 1/4" long 6-32 flathead screws in the center of the cover using a Phillips head screwdriver.

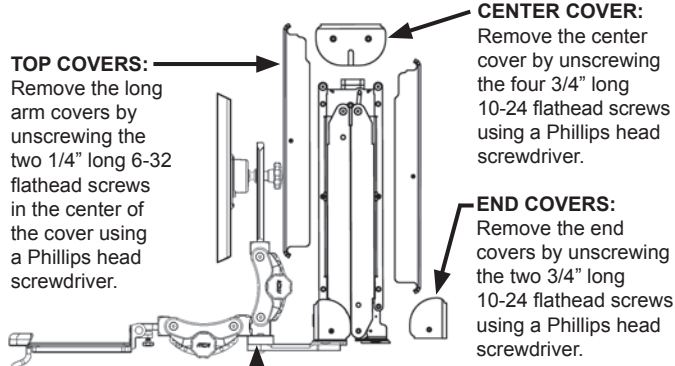

**CENTER COVER:**  
Remove the center cover by unscrewing the four 3/4" long 10-24 flathead screws using a Phillips head screwdriver.

**END COVERS:**  
Remove the end covers by unscrewing the two 3/4" long 10-24 flathead screws using a Phillips head screwdriver.

**TORQUE 120 INCH POUNDS. DO NOT LOOSEN.**

## REATTACH ARM COVERS

### TOP COVERS:

Reattach the long arm covers by replacing the two 1/4" long 6-32 flathead screws in the center of the cover using a Phillips head screwdriver.

### CENTER COVER:

Reattach the center cover by replacing the four 3/4" long 10-24 flathead screws using a Phillips head screwdriver.

### END COVERS:

Reattach the end covers by replacing the two 3/4" long 10-24 flathead screws using a Phillips head screwdriver.

## REPLACE BOLT & BEARING ASSEMBLIES

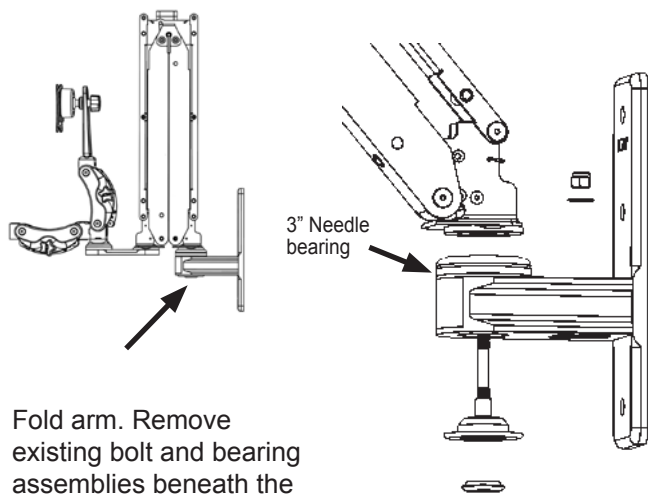

Fold arm. Remove existing bolt and bearing assemblies beneath the wall ear. Replace with new hardware provided.

This process may be easier if one person holds and lifts the arm up while a second person installs the replacement bolt and bearing assemblies.

## ATTACH MONITOR

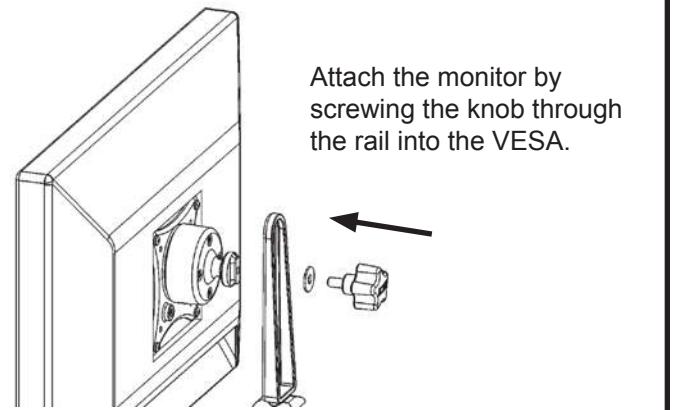

Attach the monitor by screwing the knob through the rail into the VESA.

## ADJUST ARM RESISTANCE

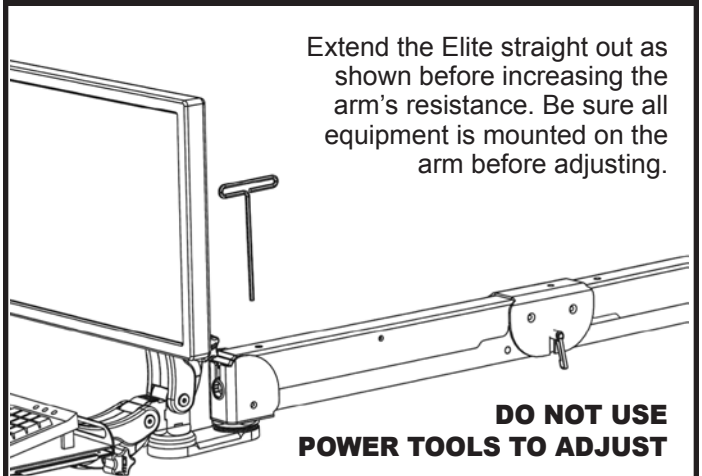

Extend the Elite straight out as shown before increasing the arm's resistance. Be sure all equipment is mounted on the arm before adjusting.

**DO NOT USE POWER TOOLS TO ADJUST**

*If you have any questions, please call our customer service representatives. They will be able to answer your installation questions.*

**Toll free 1-800-558-4435**