

ICW ULTRA ARM INSTALLATION

ICWUSA.com, Inc.

If you have any questions please call Toll Free 1-800-558-4435

IF MOUNTING TO THE ULTRA WALL TRACK

MOUNT ULTRA TRACK TO WALL

- Remove small socket head cap screw in the top center of the Wall Track. Remove plastic cover.
- Locate the wall stud and mark the top hole of the Wall Track.
- Drill 11/64 pilot hole, insert #14 screw and tighten slightly. Use a level, mark the lower holes, drill pilot holes and then insert the #14 screws.

NOTE: #14 wood screws are supplied with unit. If installing into metal studs you will need to replace these with proper metal stud fasteners or the provided snap toggles. All hardware used to secure track mount must have a proper countersunk head.

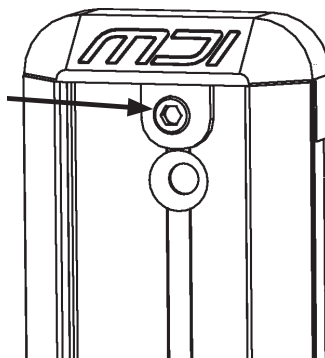

ATTACH SLIDER TO ULTRA TRACK

- Insert slider into wall track.
- Replace the plastic cover and small socket head screw.

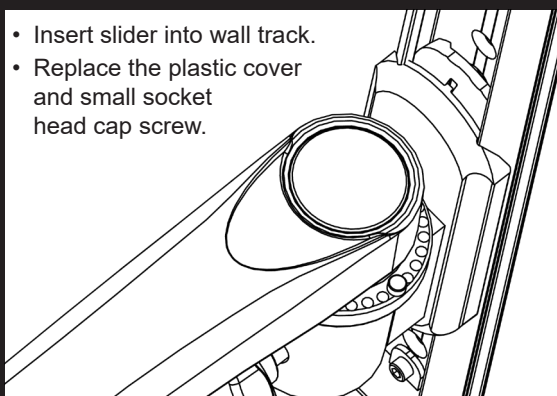

ADJUST SLIDER POSITION

STANDARD

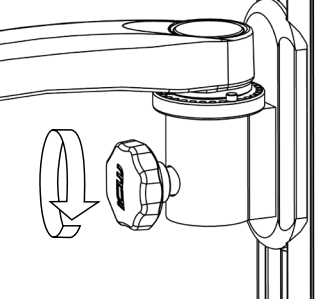

INVERTED

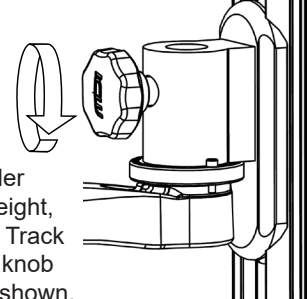

Once you have adjusted the slider to the desired height, tighten down the Track Slider using the knob on the slider as shown.

Adjust slider to desired height. Tighten slider using adjustment knob.

IF MOUNTING TO A DESK

ADJUST ULTRA DESK MOUNT

- Drill a 3/8" hole through the horizontal mounting surface (D0 installs require a 3/4" hole, not 3/8").
- Screw stud into centered hole in base of desk mount.
- Push the stud on the desk mount through the hole.
- Slide the crossbar over the stud from underneath.
- Secure in place with 3/8" nylock nut.

Desk Mount Part Number	Stud Length	Maximum Desk Thickness
D0	3.50"	2.47"
D1	3.50"	1.87"
D3	5.50"	1.87"
D5	7.50"	1.87"
D7	10.50"	2.38"

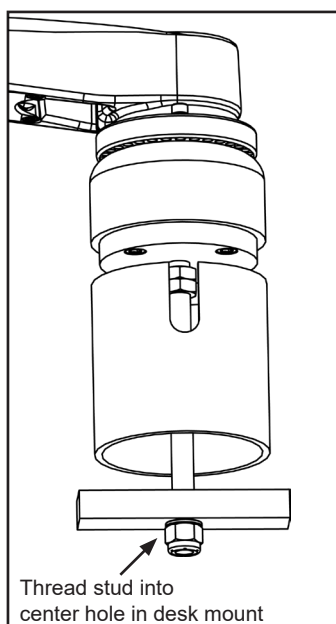

Thread stud into center hole in desk mount

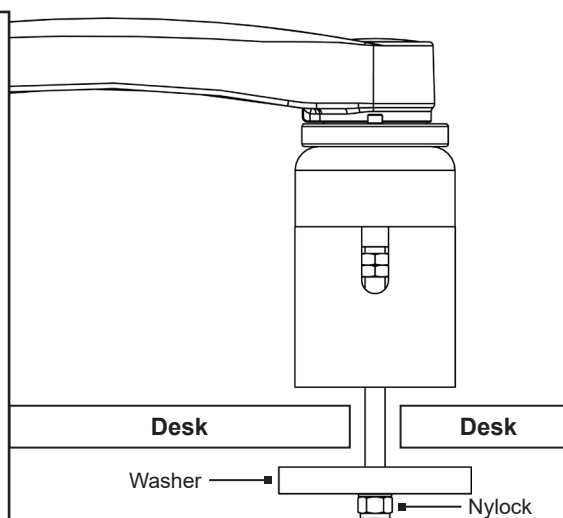

IF MOUNTING TO A WALL

ATTACH WALL PLATE TO WALL

Locate the stud and mark the top hole, drill 11/64 pilot hole and insert #14 screw and tighten slightly. Using a level, mark the lower hole and drill pilot hole, insert #14 screw and, with the unit level, tighten both screws.

NOTE: ICW supplies #14 wood screws. If installing onto metal studs, you will need to replace with proper metal stud fasteners.

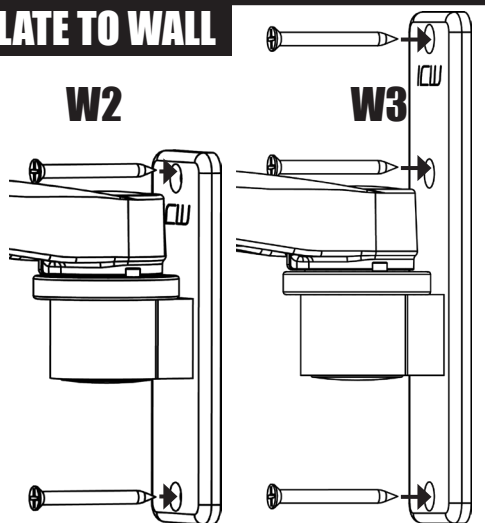

IF MOUNTING TO A POLE

ATTACH POLE CLAMP TO POLE

Using the 3/16" hex key, separate the two halves of pole mount as shown, place around pole at the desired height and reassemble.

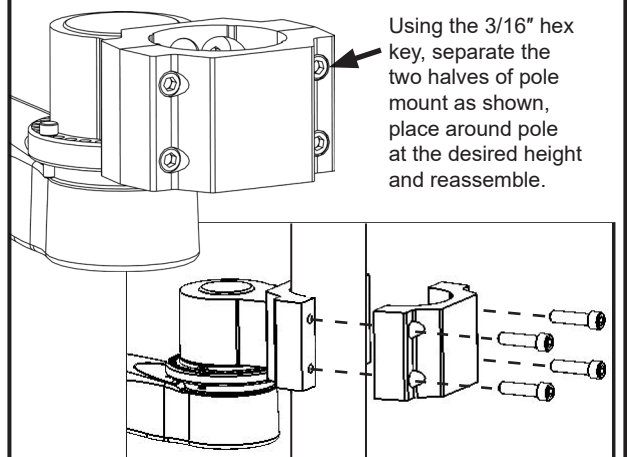

IF MOUNTING TO AN MD TRACK

ICW recommends wood or metal stud mounting only.

MOUNT WALL PLATE TO MD TRACK

- Install track as per MD track installation.
- Loosely attach track adapters to wall ear (W2, W3 or W5).
- Slide wall ear with loosely attach track adapters into MD track.
- Once in desired position, tighten one track adapter with 5/32 Allen wrench.
- Check to ensure wall ear is level and tighten remainder of track adapters.

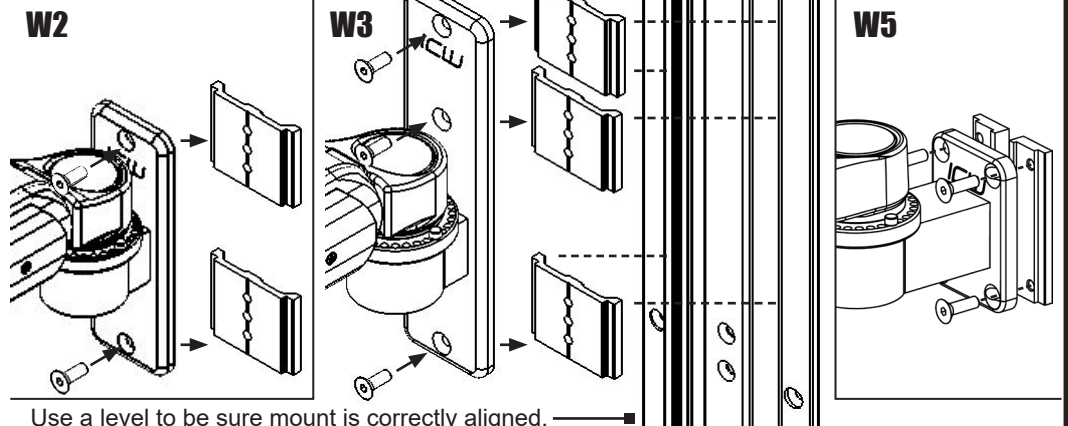

Use a level to be sure mount is correctly aligned.

ATTACH UL500 TO W2, W3 OR W5

Attach to UL500 to W2 wall mount using 3/8 bolt assembly and 1.25" bearing assembly provided. Insert bolt assembly up through wall ear. Place 1.25" bearing assembly over bolt on the other side of wall ear. Place UL500 over bolt and bearing and turn bolt until UL500 is secure and smoothly turns against the bearing.

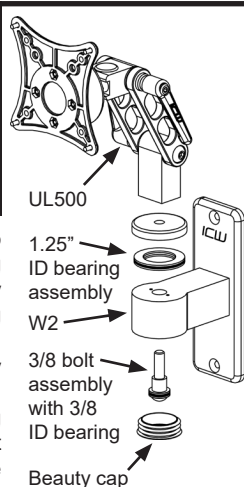

ATTACH UL510 TO W2, W3 OR W5

Attach to UL510 to W2 wall mount using 3/8 bolt assembly and 1.25" bearing assembly provided. Insert bolt assembly up through wall ear. Place 1.25" bearing assembly over bolt on the other side of wall ear. Place UL510 over bolt and bearing and turn bolt until UL510 is secure and smoothly turns against the bearing.

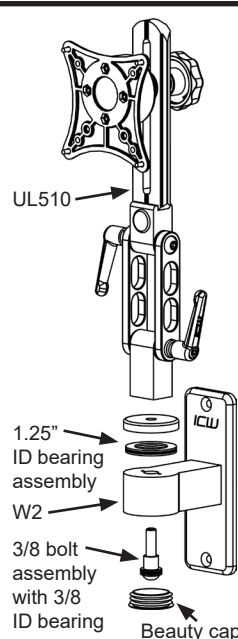

ATTACH PARALINK TO W2, W3 OR W5

Attach to Paralink to W2 wall mount using 3/8 bolt assembly and 1.25" bearing assembly provided. Insert bolt assembly up through wall ear. Place 1.25" bearing assembly over bolt on the other side of wall ear. Place Paralink over bolt and bearing and turn bolt until Paralink is secure and smoothly turns against the bearing.

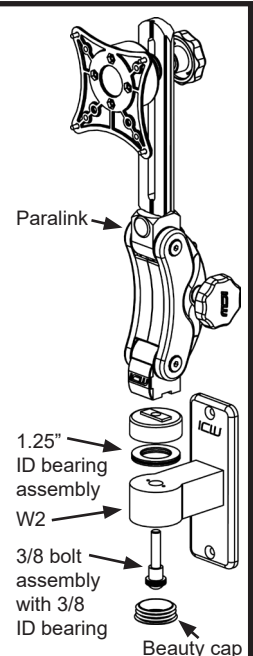

IF USING UL500

ATTACH VESA TO UL 500

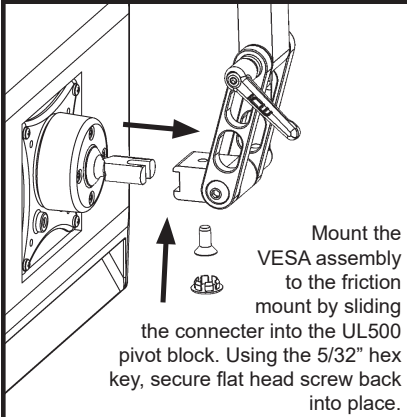

ATTACH VESA TO MONITOR

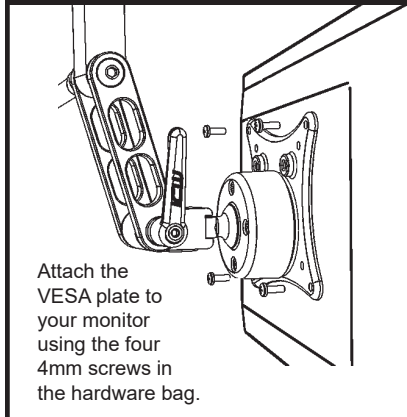

ADJUST TILT HANDLES

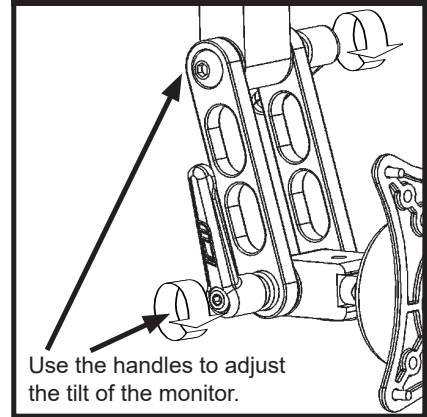

IF USING UL550

ATTACH PARALINK TO W2, W3 OR W5

Attach to Paralink to Ultra arm using 3/8 bolt assembly and 1.25" bearing assembly provided. Insert bolt assembly up through wall ear. Place 1.25" bearing assembly over bolt on the other side of wall ear. Place Paralink over bolt and bearing and turn bolt until Paralink is secure and smoothly turns against the bearing.

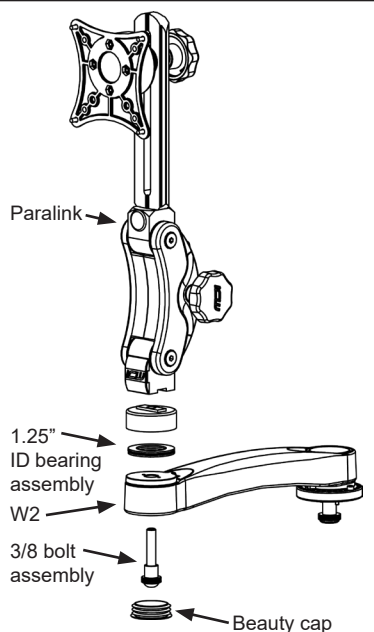

ATTACH TO MONITOR

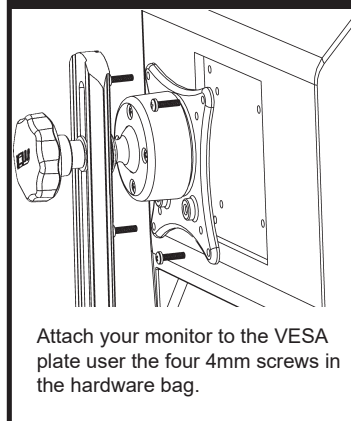

MONITOR TILT, ROTATION & ADJUST MONITOR DEPTH

MONITOR TILT & ROTATE

Gently hold sides of monitor. Tilt and rotate to desired position with ball VESA.

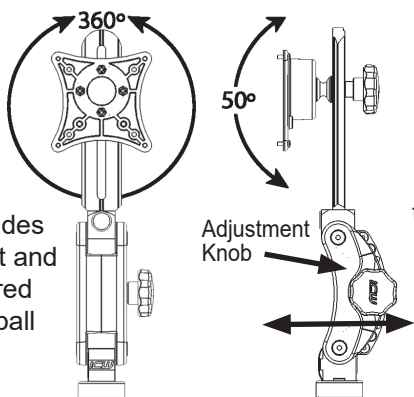

ADJUST MONITOR DEPTH
Loosen the adjustment knob, move the Paralink forward or back, then re-tighten the knob.

ADJUST BALL VESA TENSION & HEIGHT

Use the slider knob to loosen the slider to adjust the height of the monitor on the Paralink.

Adjust the pivot tension of the ball by gently and evenly tightening or loosening the four screws on the back of the ball VESA.

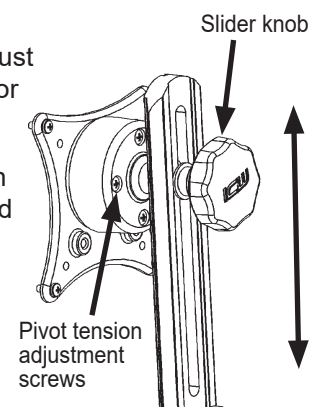

IF USING UL510

ATTACH VESA

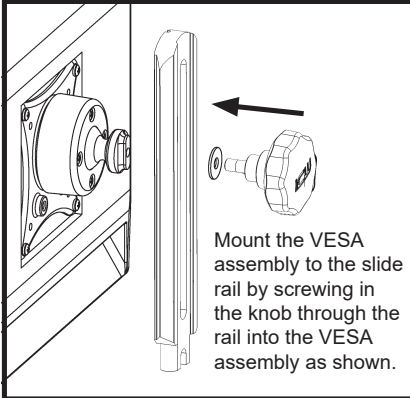

ATTACH TO MONITOR

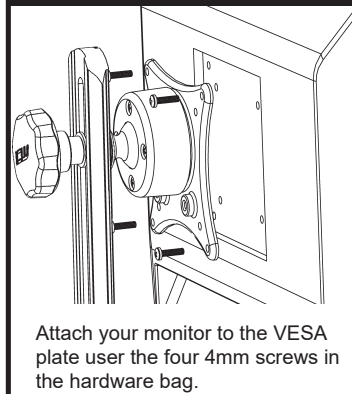

ADJUST TILT & MONITOR HEIGHT

Adjust the height of the monitor along the rails of the 510. Then tighten in place using slider knob.

Slider Knob

Use the handles to adjust the tilt of the monitor.

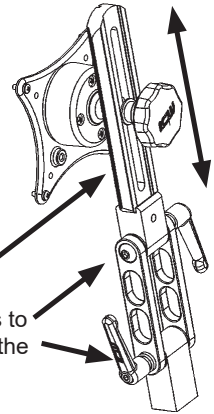

IF USING PARALINK KEYBOARD TRAY

ATTACH PARALINK

1. Remove beauty cap on Paralink.
2. Remove screw using 3/16" hex key.
3. Slide keyboard tray into Paralink.
4. Replace screw and tighten.
5. Replace beauty cap.

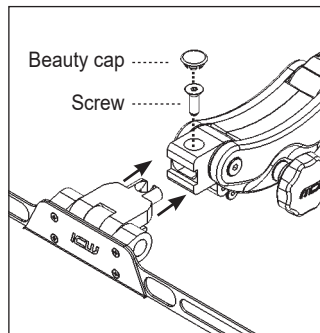

IF USING ULTRA KEYBOARD TRAY

ATTACH FLIP UP

1. Remove screws from drop extension using 5/32" hex key.
2. Align holes in keyboard tray with screw holes in drop extension.
3. Attach keyboard tray using the provided screws.

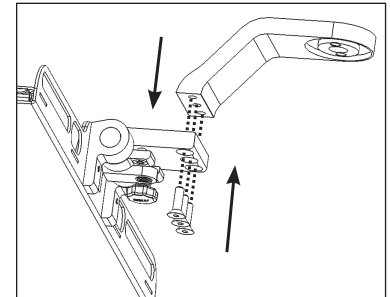

ULTRA CORD MANAGEMENT

1. Prepare all cables to route within the arm by placing them near cavity of arm and bundling together if necessary.
2. Remove cover by unscrewing four socket head cap screws. Screws are captured by the cover so they cannot fall out. Once screws are disengaged, pull cover out of arm.
3. Place cables within the channel. Do not block the holes where screws will engage in arm.
4. Replace cover and tighten screws. Cables should be able to pull through to desired position if necessary.

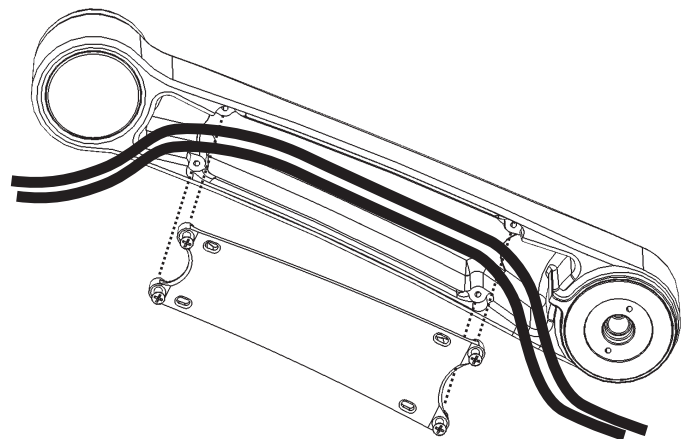

CLEANING OF THE ICW MOUNTING DEVICE

When cleaning your ICW mounting unit please follow the points below. Proper cleaning of the mounting device will help assure proper function and extend the life of the unit.

1. Any general cleaner is acceptable except degreasers are not recommended near the bearing entrances.
2. Spray cleaner or water on a soft cloth or paper towel and then wipe down the mounts.
3. Do not spray directly at the bearing seams (located at all swivel points) as this could reduce the life of the bearings.

NOTICE: ICWUSA.COM, Inc. provides the appropriate hardware fasteners to match the majority if not all standard monitors and devices. It is the responsibility of the installer / integrator to ensure that the screws and fasteners have the adequate thread engagement. The rule of thumb is that the thread depth is greater than the diameter of the hole or 4 full turns of 360 degrees of thread engagement. It is also the responsibility of the installer / integrator to ensure that they do not damage the monitor or device by using a screw or fastener that is too long for hole and therefore damaging the unit by inserting too far.