

# ICW WORKSURFACE TRAY INSTALLATION

ICWUSA.com, Inc.

If you have any questions, please call 1-800-558-4435

## IF ATTACHING TO DROP EXTENSION

### ATTACH FLIP UP

1. Remove screws from drop extension using 5/32" hex key.
2. Align holes in keyboard tray with screw holes in drop extension.
3. Attach keyboard tray using the provided screws.

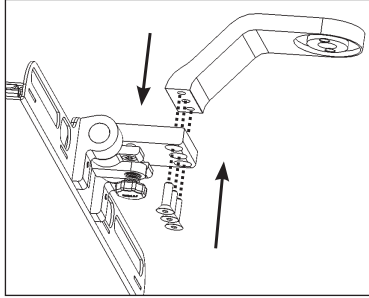

## IF ATTACHING TO QUICK DISCONNECT

### ATTACH QUICK DISCONNECT

1. Remove beauty cap on quick disconnect block.
2. Remove screw using 3/16" hex key.
3. Slide keyboard tray into quick disconnect block.
4. Replace screw and tighten.
5. Replace beauty cap.

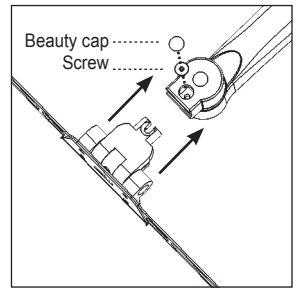

## CABLE MANAGEMENT

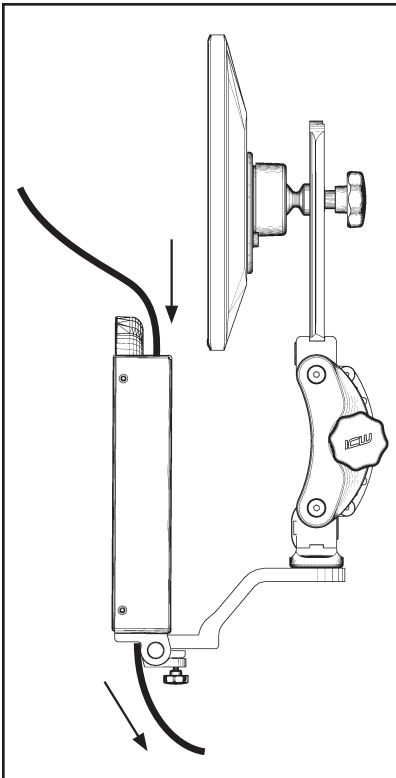

- Flip up WorkSurface tray into vertical position.
- Drop keyboard cable through tray from top.
- Cable should exit from back of tray.
- If necessary, pull out keyboard tray for better access.

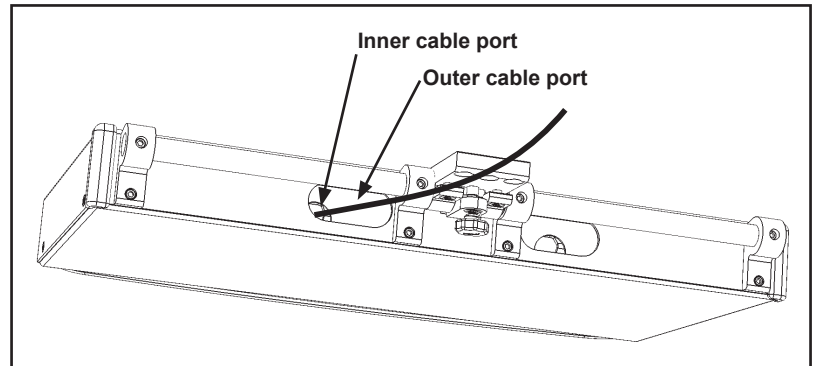

- Thread cable through inner and outer ports in back of WorkSurface tray.
- Store excess cable inside tray.