

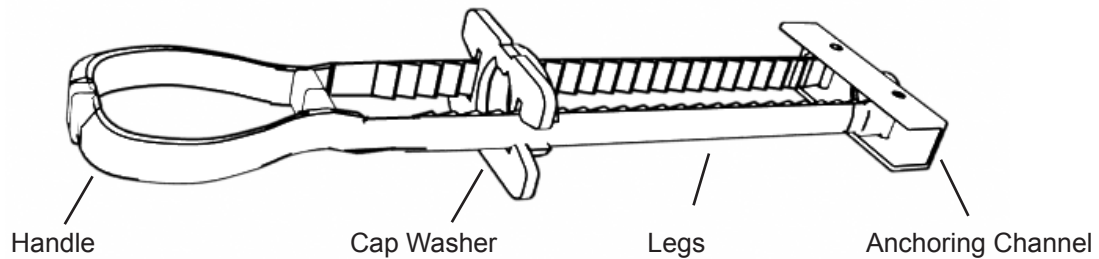

Toggle Mounting System



NOTE: The wall mount must be secured by all three of its mounting holes, the following steps will need to be done for each mounting hole.

1 Drill a 1/2 inch hole in the wall you are going to mount your arm on. Gently flex the toggle system so that the anchoring channel is parallel with the toggle legs. Slide toggle into the hole and allow the anchoring channel to straighten against the backside of the wall.

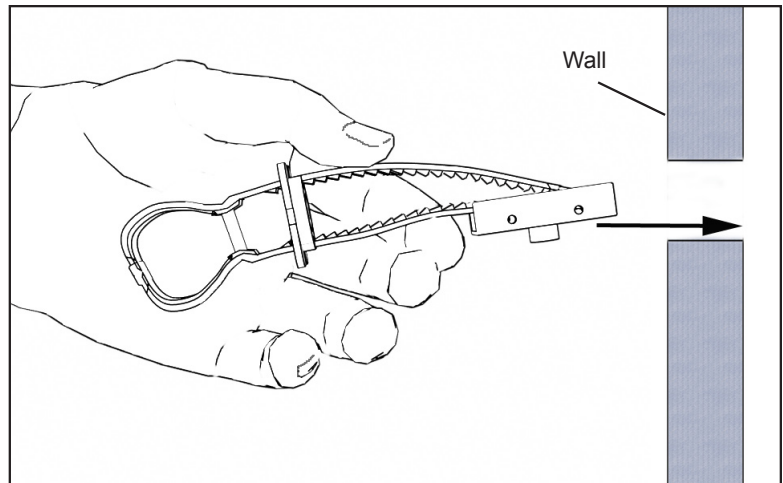

2 While holding on to the toggle handle with one hand and keeping the anchoring channel against the inside of the wall, use other hand to slide the cap washer forward until it firmly presses against the wall and holds the toggle in place.

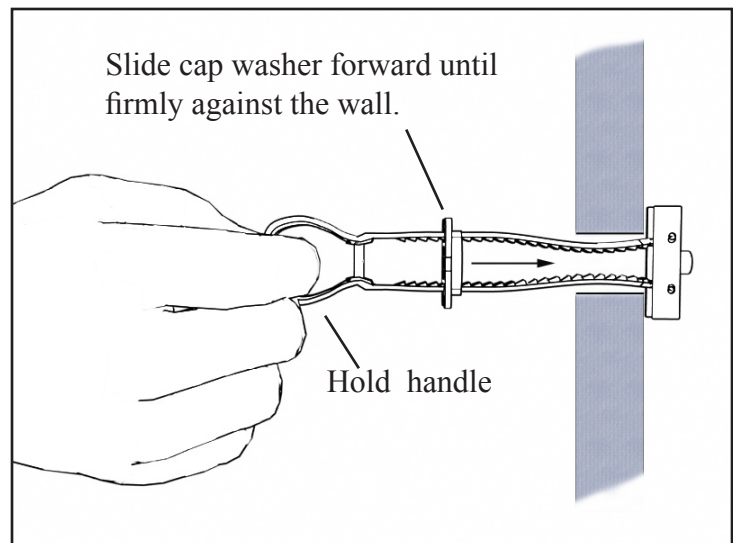

3 With the toggle held in place by the cap washer, place thumb between the toggle legs and gently snap off the legs and toggle handle as close to the wall as possible.

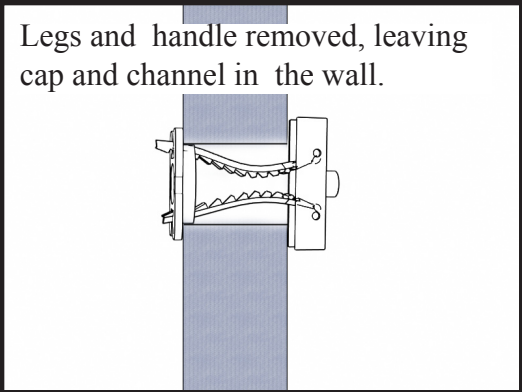
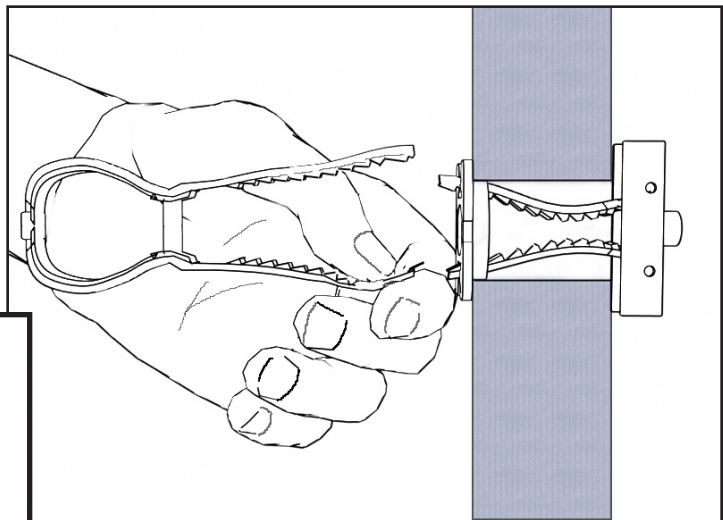
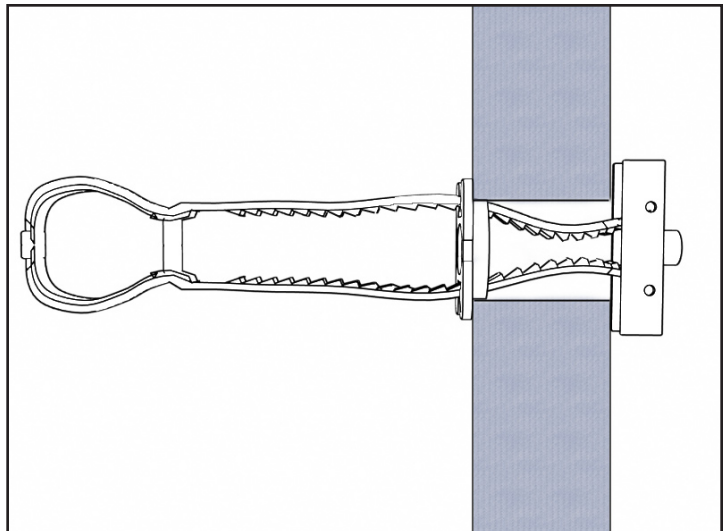

4 Using the provided 1/4-20 bolts, secure the wall mount to the wall by passing the bolt through the wall mount and the wall, and screwing it firmly into the anchoring channel.

